

Gray Street, Bootle  
Bootle, L20

Leasehold  
£125,000



- \*Newly Refurbished Three bedroom End Terraced House
- \*Two bathrooms
- \*Extended to Ground Floor
- \*Open Plan Lounge / Dining Room
- \*Private rear Courtyard
- \*Ground Floor Bathroom



97 | SOUTH ROAD | WATERLOO | L22 0LR  
Tel: 0151 920 2404  
E-mail: [info@logicstates.co.uk](mailto:info@logicstates.co.uk)





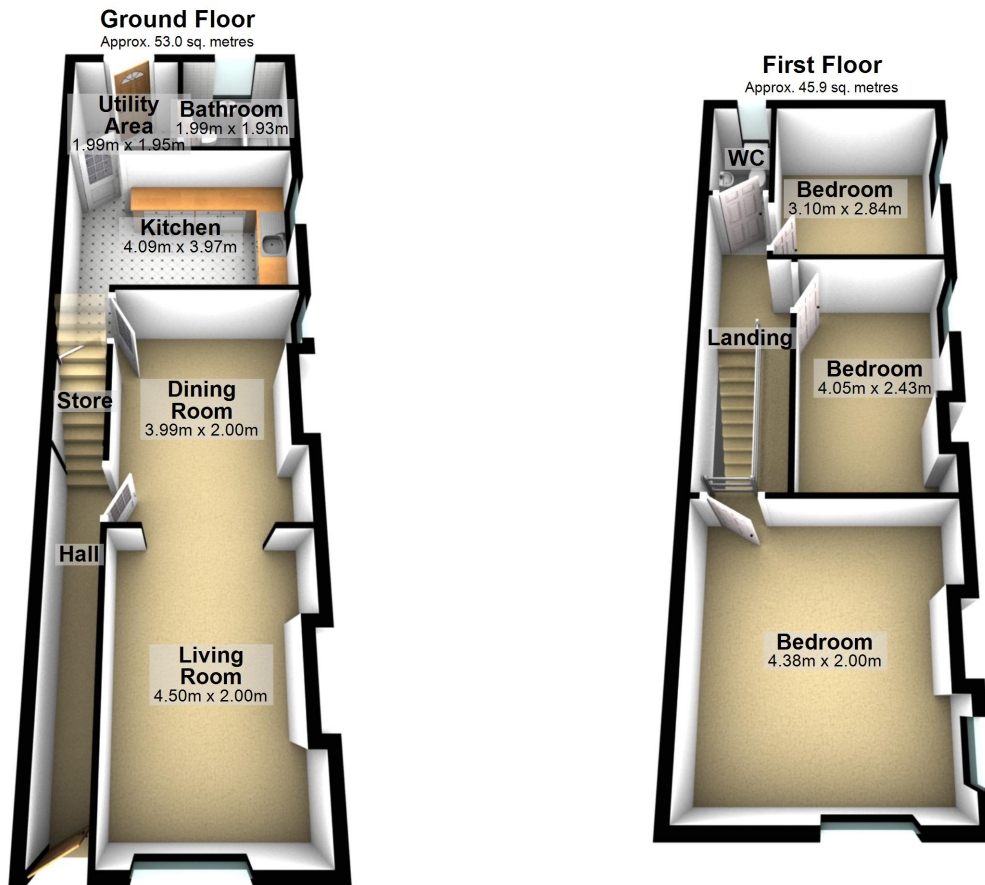

Total area: approx. 98.9 sq. metres

Whilst every attempt has been made to ensure the accuracy of the floor plan contained here, measurements of doors, windows, rooms and any other item are approximate and no responsibility is taken for any error, omission or misstatement.  
Plan produced using PlanUp.

These particulars do not form part of any offer or contract and must not be relied upon as statements or representations of fact. Any areas, measurements or distances are approximate. The text, photographs and plans are for guidance only and are not necessarily comprehensive. It should not be assumed that the property has all the necessary planning, building regulation or other consents and we have not tested services, equipment or facilities. Purchasers must satisfy themselves by inspection or otherwise.

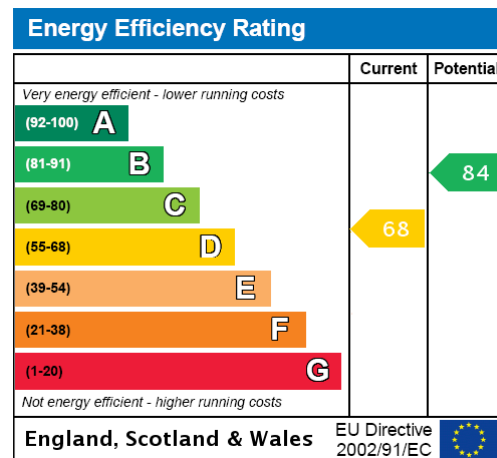

- \*Newly Refurbished Three bedroom End Terraced House
- \*Two bathrooms
- \*Extended to Ground Floor
- \*Open Plan Lounge / Dining Room
- \*Private rear Courtyard
- \*Ground Floor Bathroom
- \*First floor WC and Washroom
- \*Central Heated and Double Glazed
- \*Three Double Bedrooms
- \*Corner Position
- \*No Chain

Title Number - MS604538

Local Authority - Sefton

Council tax - Band A

Estimated Annual Council Tax Cost - £1,641

Tenure - Leasehold

Lease Start Date 25/06/1906

Lease End Date 25/03/2904

Lease Term 999 years from 25 March 1905

Lease Term Remaining 878 years

Conservation Area - No

Flood Risk

Rivers & Seas: Very Low

Surface Water: Very Low

Satellite / Fibre TV Availability - BT, Sky

(Data source from Sprift)

'Unusually good at what we do'

97 | SOUTH ROAD | WATERLOO | L22 0LR

Tel: 0151 920 2404

E-mail: [info@logicstates.co.uk](mailto:info@logicstates.co.uk)





Sell with a multi - "National award winning Estate Agent!"  
'Straightforward Sales & Lettings'

These particulars do not form part of any offer or contract and must not be relied upon as statements or representations of fact. Any areas, measurements or distances are approximate. The text, photographs and plans are for guidance only and are not necessarily comprehensive. It should not be assumed that the property has all the necessary planning, building regulation or other consents and we have not tested services, equipment or facilities. Purchasers must satisfy themselves by inspection or otherwise.