

St Edmonds Road
Liverpool, L20

Leasehold
£335,000



- *Substantial Victorian Seven Bedroom Semi Detached House
- *External Brick Outbuilding
- *Four Floors
- *Basement
- *Three Reception Rooms
- *Ground Floor WC



97 | SOUTH ROAD | WATERLOO | L22 0LR
Tel: 0151 920 2404
E-mail: info@logicstates.co.uk



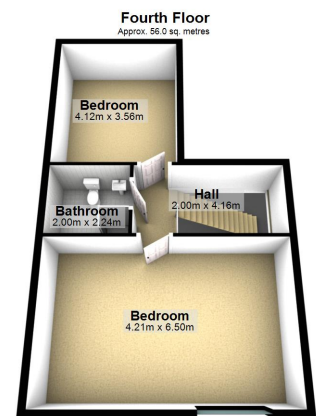
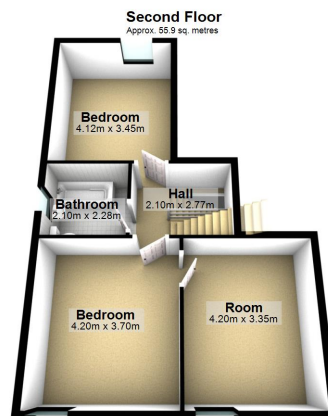

Total area: approx. 239.2 sq. metres

Whilst every attempt has been made to ensure the accuracy of the floor plan contained here, measurements of doors, windows, rooms and any other item are approximate and no responsibility is taken for any error, omission or misstatement.
Plan produced using PlanIt

These particulars do not form part of any offer or contract and must not be relied upon as statements or representations of fact. Any areas, measurements or distances are approximate. The text, photographs and plans are for guidance only and are not necessarily comprehensive. It should not be assumed that the property has all the necessary planning, building regulation or other consents and we have not tested services, equipment or facilities. Purchasers must satisfy themselves by inspection or otherwise.



- *Substantial Victorian Seven Bedroom Semi Detached House
- *External Brick Outbuilding
- *Four Floors
- *Basement
- *Three Reception Rooms
- *Ground Floor WC
- *Kitchen / Breakfast Room
- *Four First Floor Bedrooms
- *Three Second Floor Bedrooms
- *Second Floor Shower Room
- *Long Leasehold Residue 999 Years
- *Rare opportunity to purchase a substantial family home

Title Number - MS484134

Local Authority - Sefton

Council tax - Band C

Estimated Annual Council Tax Cost - £2,187

Tenure - Leasehold
868 Years Remaining

Conservation Area - No

Flood Risk
Rivers & Seas: Very low
Surface Water: Very Low

Satellite / Fibre TV Availability - BT, Sky, Virgin

(Data source from Sprift)

'Unusually good at what we do'
Sell with a multi - "National award winning Estate Agent!"
'Straightforward Sales & Lettings'

These particulars do not form part of any offer or contract and must not be relied upon as statements or representations of fact. Any areas, measurements or distances are approximate. The text, photographs and plans are for guidance only and are not necessarily comprehensive. It should not be assumed that the property has all the necessary planning, building regulation or other consents and we have not tested services, equipment or facilities. Purchasers must satisfy themselves by inspection or otherwise.